

2019.08

室内用被动红外探测器 分体式感应门铃

KS-SF20R

使用说明书



产品简介

- * 开门迎宾客、打烊防盗贼, 迎宾 / 门铃 / 警报 / 彩灯 / 小夜灯五项功能提醒, 老板们的秘密助手。
- * 可选配学习 32 个红外、门磁、振动等无线探头配件, 及 8 个遥控器, 灵活多用途。
- * 多彩 LED 灯, 亮度可调, 可用不同颜色区分多个出入口, 更炫、更聪明。
- * 适用于各种店铺、高档会所、酒店、办公室、工厂、家庭、别墅等等场所。
- * 远距离传输, 空旷达到 280 米, 适合更大场所, 更高楼层。
- * 独立警报专用喇叭, 最大达 113dB, 能有效吓退小偷。
- * 音量可调, 换电池记忆等人性化设计, 更体贴、更舒心。
- * 8 和弦音乐芯片, 40mm 大喇叭, 更悦耳、更大声。

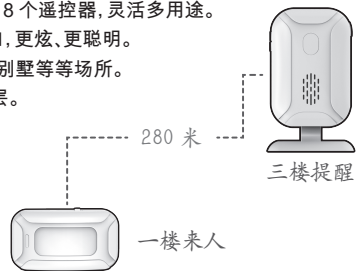

应用建议: 分体迎宾器, 家庭防盗, 车库防盗, 感应门铃, 感应小夜灯和七彩灯等等, 更多应用等你探索!

1 外观结构

1.1 红外幕帘 (图示一)

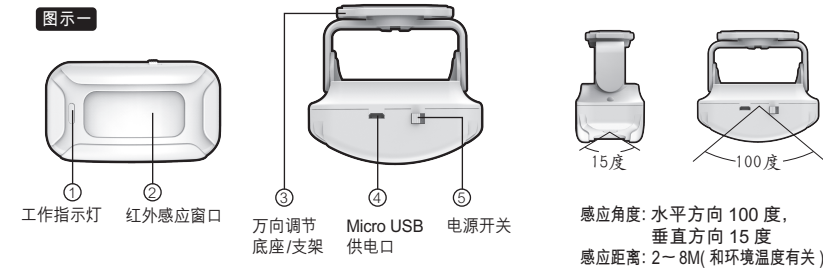

感应角度: 水平方向 100 度, 垂直方向 15 度
感应距离: 2~8M(和环境温度有关)

1.2 接收机 (图示二)

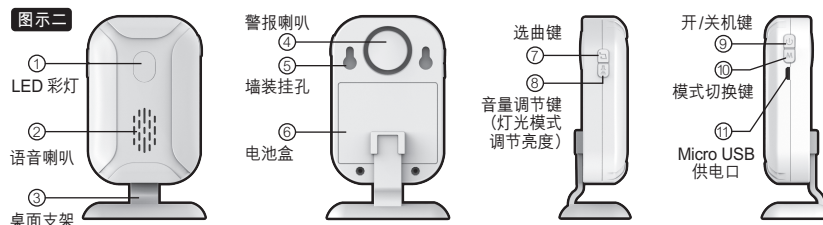

Wireless Welcome Doorbell Motion Sensor Alarm / Chime / Alert

SF20R (Receiver) WLS10 (Infrared Curtain)
Instructions



Features

- Shop Keeper in day time, anti-thief in the night, welcome / doorbell / alarm / color lights / lighting 5in1 multi-function.
- Remote transmission range up to 280M / 918ft in the open space.
- 8 channel music chip, 40mm big horn, 36 chime melodies, remember your last set melody and volume level once powered off.
- Colorful LED lights, adjustable brightness, distinguish multiple entrances by different colors.
- 4 stages adjustable volume (Loud/High/Middle/Low) from 113-25dB.
- Receiver can learn from up to 32 wireless sensors like PIR motion, magnetic or vibration sensor as well as up to 8 remote controllers.

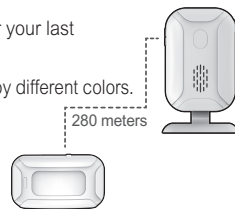

Application: shops, Commercial Complex, Luxury hotels, offices, factories, homes, villas, driveways, walking paths, Supermarkets, restaurants etc.

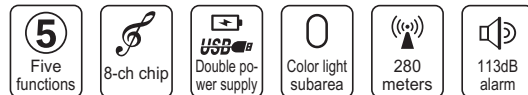

FCC WARNING

This device complies with part 15 of the FCC Rules. Operation is subject to the following two conditions: (1) this device may not cause harmful interference, and (2) this device must accept any interference received, including interference that may cause undesired operation.

Any changes or modifications not expressly approved by the party responsible for compliance could void the user's authority to operate the equipment.

NOTE: This equipment has been tested and found to comply with the limits for a Class B digital device, pursuant to Part 15 of the FCC Rules. These limits are designed to provide reasonable protection against harmful interference in a residential installation. This equipment generates, uses and can radiate radio frequency energy and, if not installed and used in accordance with the instructions, may cause harmful interference to radio communications. However, there is no guarantee that interference will not occur in a particular installation.

If this equipment does cause harmful interference to radio or television reception, which can be determined by turning the equipment off and on, the user is encouraged to try to correct the interference by one or more of the following measures:

- Reorient or relocate the receiving antenna.
- Increase the separation between the equipment and receiver.
- Connect the equipment into an outlet on a circuit different from that to which the receiver is connected.
- Consult the dealer or an experienced radio/TV technician for help.

To maintain compliance with FCC's RF Exposure guidelines, This equipment should be installed and operated with minimum distance between 20cm the radiator your body: Use only the supplied antenna.



FCC ID: 2ANPS-KSSF20R

1.3 遥控器 (选配) (图示三)

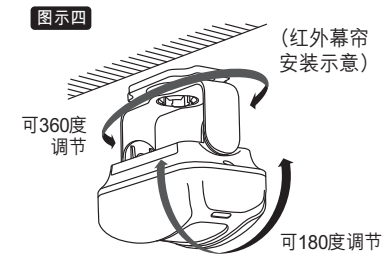
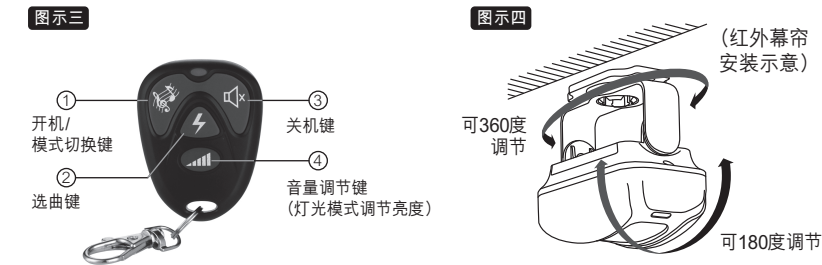

2 功能与使用说明

2.1 电池和电源

- 2.1.1 红外幕帘装入 3 颗 7 号 (AAA) 碱性电池, 接收机装入 3 颗 5 号 (AA) 碱性电池, 请注意电池极性。
- 2.1.2 接收机第一次通电亮彩灯, 响嘟一声, 然后再响开机提示音, 进入开机状态; 红外幕帘打开电源开关 LED 指示灯会亮呼吸灯 5 次, 表示电池安装正确。
- 2.1.3 建议使用碱性电池, 使用其它电池待机时间会变短, 声音会变小声; 也可使用 Micro USB 电源供电, 电池会自动断开, 待停电时使用。

1. Description of Structure

1.1 Infrared Curtain (Transmitter)

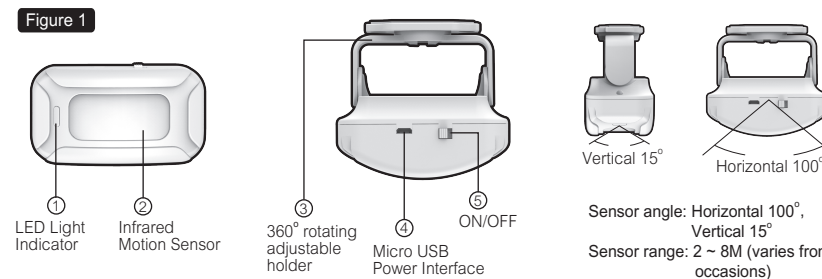

Sensor angle: Horizontal 100°, Vertical 15°
Sensor range: 2 ~ 8M (varies from occasions)

1.2 Receiver

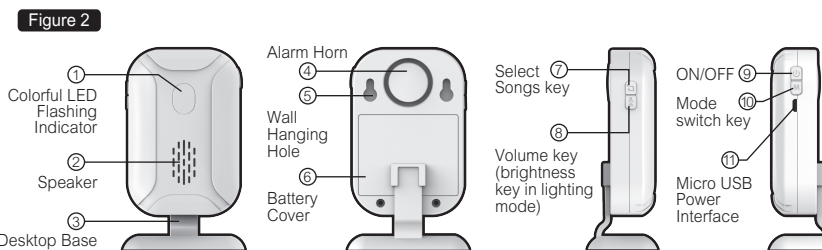

2.2 安装位置

2.2.1 红外幕帘建议安装在顾客进出门的顶部天花板或侧面; 如用于防盗, 请安装在盗贼容易入侵的过道位置。建议使用螺丝安装, 双面胶安装适用于平整光滑的表面, 否则容易掉落。

- * 本机被动检测人体表面温度 34 度左右释放的红外线信号的变化量, 请参考 (图示四) 红外幕帘调节感应窗口的方向。
- * 本机为室内用, 请不要安装在阳光直晒或雨淋的地方。为了减少误报, 应避免空调口, 风扇, 风口等温度变化大, 干扰较大的地方安装。

2.2.2 接收机建议用支架摆放在桌面, 方便灵活移动, 也可用螺丝挂墙安装。

2.2.3 安装好后, 按接收机开机键进入迎宾提醒模式, 测试无线传输距离, 调整红外幕帘的检测角度, 反复测试确保人从门的不同位置进入时能感应到, 并触发主机播放声音。

2.3 使用和操作

2.3.1 本机出厂时, 接收机和红外幕帘已经默认学习配对好

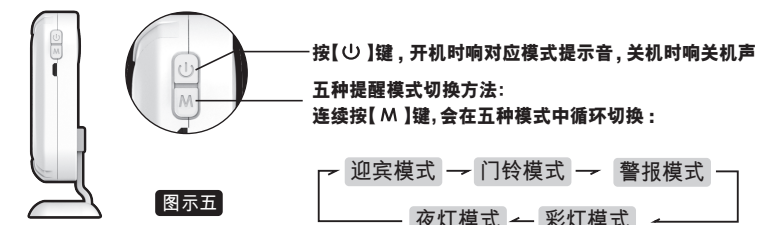

1.3 Remote controller (optional)

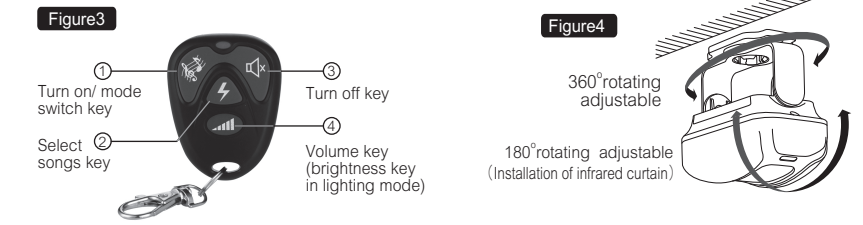

2. Function Description

2.1 Batteries and Power

- 2.1.1 3*AAA alkaline batteries for PIR Transmitter, 3*AA for Receiver, please note the negative and positive.
- 2.1.2 You will hear short "DU" and see LED colorful lights flashing after loading the batteries for receiver. Load the batteries, turn on the transmitter, the LED indicator will be on for 5 seconds.
- 2.1.3 Alkaline batteries are recommended, other types will shorten standby time and lower the alarm volume. Micro USB is alternative for power supply; battery supply will be automatically cut off if AC power, and can be standby power supply if power off.

2.2 Installation

2.2.1 Install the transmitter in the ceiling or aisle of the entrance where customers and intruder go back and forth. Installation by screws will be more firm than double-sided tap which requires tidy and smooth surface.

* The transmitter detects the infrared signal range released from body surface temperature of 34 °C, please take the 1.3 (Figure 4) for installation adjustment reference.

反面

2.3.2 本机有五项功能提醒模式,说明和操作参考下表

	迎宾提醒模式 (默认)	门铃提醒模式	警报提醒模式	彩灯提醒模式	夜灯提醒模式
模式提示	播当前迎宾音 彩灯跳变闪烁	播当前乐曲 彩灯跳变闪烁	DiDiDi 三声 红色灯光	无声 彩灯跳变闪烁	无声 亮白灯 2 秒
	备注: 播放提示音时只预览 5 秒; 断电有记忆功能, 再通电会恢复到断电前的功能模式。				
探头触发声音效果	“叮咚”+ 所选迎宾音	所选乐曲	响警报警音 30 秒	—	—
探头触发灯光效果	按探头学习的区域颜色亮灯提示				亮白灯 2 分钟
【 J] 选曲键	循环选择 5 首迎宾音	循环选择 36 首门铃乐曲	选择“警报警音”	无功能	
【 M] 音量键	可调节 4 级喇叭音量			可调节 4 级灯光亮度	
遥控器说明	遥控器有 4 个按键, 关机键独立出来, 短按即可关机, 更加方便				
撤防和静音打断功能	撤防功能: 在警报触发时, 连续响报警声 30 秒的过程中, 按主机电源键, 或短按遥控器关机键, 可以撤防并关机。 静音打断功能: 其他情况触发时, 播放声音或灯光点亮的过程中, 可短按任意键 (遥控器关机键除外) 提前静音和打断, 回到在触发前的状态。				

2.4 学习配件(红外幕帘、门磁、振动等)或遥控器
如要增加红外幕帘、门磁、振动等探头配件, 或者增加遥控器, 可进行学习配对。步骤见(图示六):
注意: 每个颜色区域可学习 8 个无线探头配件, 4 个颜色区域合计 32 个。当前区域学满后会循环覆盖。
遥控器不占用颜色区域, 学习遥控器时不必理会灯的颜色; 遥控器最多可学习 8 个, 学满后会循环覆盖。

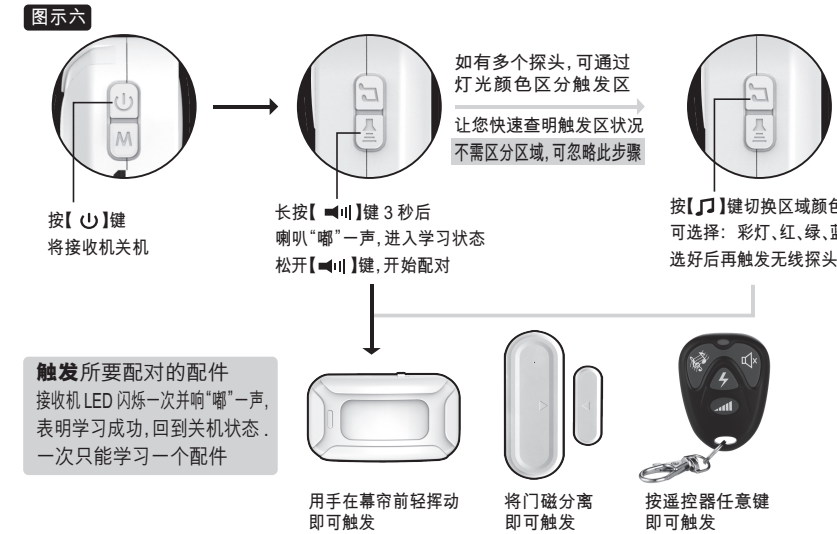

2.5 配件全删功能(图示七):
请谨慎此操作!

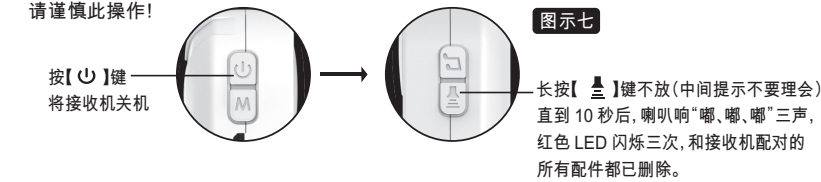

3 更换电池提示

1. 红外幕帘电池电量不足时 LED 每 3 秒闪烁 1 次, 请及时更换电池。
2. 接收机电池电量不足时, 开机或模式切换会有低电声, 请及时更换电池; 当电池电量过低时, 接收机将失去所有功能, 按键只提示低电声, 请立即更换电池。
3. 遥控器指示灯变暗或遥控距离很短时, 请及时更换电池。

4 技术参数

- 4.1 接收机使用 3 颗 5 号 (AA) 碱性电池或 Micro USB 电源供电。
- 4.2 红外幕帘 3 颗 7 号 (AAA) 碱性电池或 Micro USB 电源供电。
- 4.3 接收机电池可用 5~7 个月 (每天响 30 次计算)。
- 4.4 红外幕帘电池可用 5~7 个月 (每天探测 30 次计算)。
- 4.5 发射接收频率: 433.92MHz
- 4.6 工作环境温度: 接收机: -10℃ ~ +60℃ 红外探测器: -10℃ ~ +33℃
- 4.7 工作环境湿度: <80%
- 4.8 储存温度: -20℃ ~ +70℃

* The transmitter is used for indoor only; please do not keep it exposed to the sun and rain. Had better not install it in the areas of air-conditional, fan which change the environment temperature.

2.2.2 Place the receiver with the desktop base on the desk, or fix it on the wall with the screws.

2.2.3 After installation, press the receiver ON/OFF button to enter into welcome reminder mode, test the wireless transmission distance, adjust angle of the transmitter. Try to ensure that the people come in from different position can be detected by repeating tests.

2.3 Operational Description:

2.3.1 The transmitter and receiver have been programmed in factory.

Figure 5

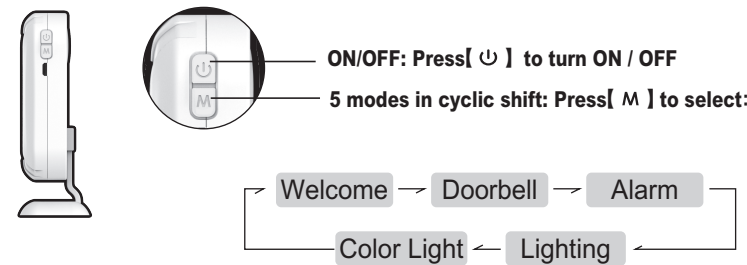

2.3.2 5 Modes with 5 functions :

	Welcome	Doorbell	Alarm	Color light	Lighting
Model reminder	Play Welcome song, Color lights flashing	Play current song, Color lights flashing	DiDiDi 3 times, Red light	No sound Color lights flashing	No sound, LED lights are on for 2 seconds
Sound effect if triggering the transmitter	“DingDong” +selected Welcome song	Selected song	Alarm for 30 seconds;	—	—
Light effect if triggering transmitter	LED lights colors vary depending on the programmed areas				white light will be on for 2 minutes
【 J] Selection songs key	Cyclic 5 welcome songs for option	Cyclic 36 welcome songs alternative	Option for ‘Alarm’	No function	
【 M] Volume key	4 levels volume			4 levels brightness	
Instruction of remote control	4 buttons on remote control ,short press Turn- Off button to turn off the receiver				
Disarm and mute interrupt function	Disarm function: If in Alarm Mode, it will alarm for 30 seconds, press the receiver power button, or short press remoter turn-off button to disarm or switch off. Mute interrupt function: when triggering the alarm in Doorbell Mode and Lighting Mode, it will play songs or LED lights will be lighting, short press any key (except turn-off button on remote control) can end the corresponding mode.				

2.4 Program accessories (infrared curtain, magnet sensor, vibration sensor etc.) or remote control
If add vibration, infrared, magnetic detector, or remote control, do the program.

Note: Each color can be programmed with 8 wireless sensors, in total 32 by 4 colors. There is no any relation between remote control and colors. Up to 8 remote control can be programmed, if over certain amount, the latter will cover the former.

Figure 6

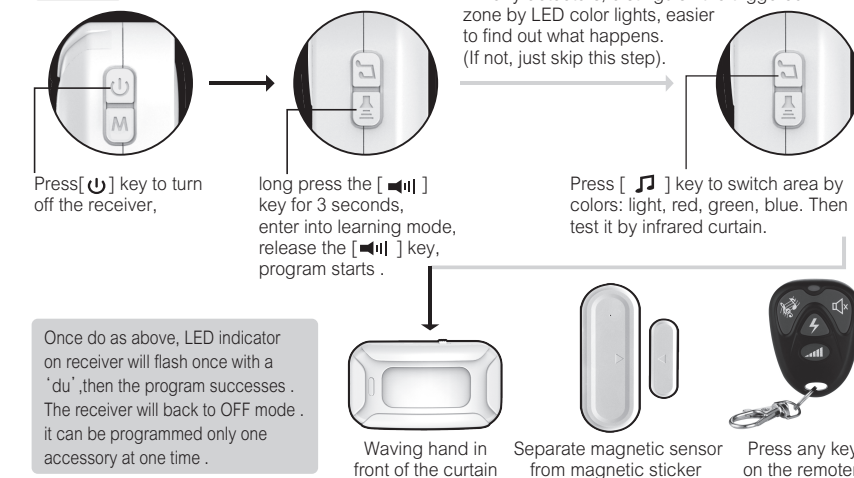

保修服务

感谢您购买本公司产品, 本产品是符合中国国家质量标准以及国际标准的优良产品, 请您放心使用。请保留好此卡。

在购买日期后一年内, 凡经本公司特约维修站人员确认为正常情况下, 因制造工艺、技术、器件造成损坏影响的, 您都将获得免费维修服务。

下列情况不能获得免费服务:

1. 超出有效服务或免费维修期限的。
2. 使用不正当引起的人为损坏, 例如不适当安装、不依说明书使用、错误使用造成损坏等。因运输或其它意外造成之损坏。其他因不可抗力(如自然灾害、电压异常等)造成的损坏。
3. 正常使用的产品老化、磨损等, 但不影响产品的正常使用。
4. 其他非产品设计、技术、制造、质量等问题而导致故障损坏。

产品保修卡

用户姓名	购买日期	产品型号
商家名称	整机编码	电话
用户地址		
详情 产品 故障 原因		
详情故障		
故障原因及处理情况		修理人员签字
维修记录		

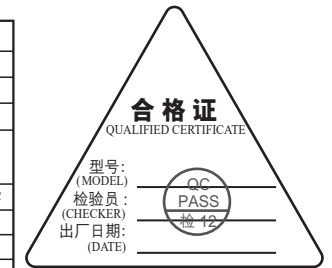

2.5 Delete all accessories: please be caution with this operation!

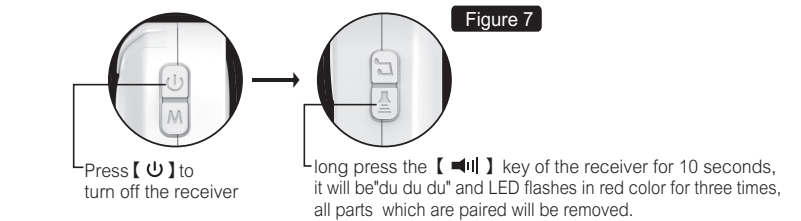

3. Low Battery Indication

- 3.1 Infrared curtain: It is in low battery if LED flashes once every 3 seconds. Please replace the battery in time.
- 3.2 Receiver: If you hear the low battery indication sound when it is in application, please replace the battery in time, or all functions cannot be realized.
- 3.3 LED indicator gets darker or wireless range gets shorter, please replace the battery in time.

4. Parameters

- 4.1 Power Supply: 3* AA for Receiver or Micro USB
3*AAA alkaline for PIR Transmitter or Micro USB
- 4.2 Battery Lifespan: 5-7months (based on 30 times per day)
- 4.3 Working Frequency: 433.92 MHz
- 4.4 Working Temperature: Receiver : -10℃ ~ +60℃ Infrared curtain : 10℃ ~ +33℃
- 4.5 Operating Humidity: < 80%
- 4.6 Storage Temperature: -20℃ ~ +70℃